

1402 S. Grand Blvd. M226
St. Louis, MO 63104
Phone: 314-977-9870
Fax: 314-977-9825
www.slu.edu

**SAINT LOUIS
UNIVERSITY**

Office of Admissions

School of Medicine
Health Sciences Center

June, 2011

**TO: Members of the Class of 2015 of the Saint Louis University
School of Medicine**

This document will answer some of your questions, remind you of certain responsibilities, and to tell you about some of the scheduled beginning-of-the-year activities.

CALENDAR

The White Coat Ceremony will begin the academic year on Sunday, July 31, 2011 at St. Francis Xavier College Church. Orientation will continue with Freshman Convocation on Monday, August 1, 2011 at 8:30 a.m. This important activity is held in the Student Education Union. This event will be followed by Orientation events on Tuesday, Wednesday, Thursday, and Friday. You begin your medical studies on Monday morning, August 8, 2011. A class schedule will be given to you during Orientation.

You must notify the Admissions Office if you will not be present on July 31st for the White Coat Ceremony.

CORRESPONDENCE

Entering students should continue to address correspondence regarding academic status to the Committee on Admissions of the School of Medicine. Update your AMCAS application with any changes in your biographical information.

If you choose to forego entering the medical school freshman class, notify the school immediately, initially by phone, so that your place may be offered to an applicant still awaiting the opportunity to enter medical school. Withdrawal by phone must be followed by written notice.

LODGING AND BOARD

Housing information is available on our web site at: <http://medschool.slu.edu/housing/>.

For the convenience of students, there are two cafeterias; one located in the University Hospital, and one located in the School of Allied Health Professions and a Café in the Student Education Union.

MICROSCOPES

The School of Medicine provides microscopes for first and second year medical students.

TEXTBOOKS, INSTRUMENTS, AND SUPPLIES

We advise you to wait until class begins before buying textbooks. The departments of instruction will give direction and advice concerning text and reference works. In many of the disciplines, there is a choice of text. Some students will want to have additional books. Sharing of reference materials is practicable. Books and supplies may be purchased at the medical school bookstore.

ADVICE REGARDING OUTSIDE EMPLOYMENT

For many years, it has been the policy of the School to discourage first year students who consider the possibility of undertaking remunerative employment outside of class hours during the regular school year. This policy was adopted because new students must focus all efforts on their studies. You are urged, therefore, to organize your personal budget to make provision for your financial needs throughout the entire first year in medical school. However, there are no curricular assignments during the summer following the first year.

STUDENT FINANCIAL SERVICES

The Office of Student Financial Services has provided information on their website <http://medschool.slu.edu/sfp/> or contact them by telephone at 314-977-9840 should you have any questions.

LOCKERS

Students are advised to bring a padlock for a locker. The Office of Student Affairs will write your assigned locker number on your orientation packet. The locker provides a safe repository for coats, books and other personal property not used in classroom or laboratory.

SPIRITUAL EXERCISES

Father James Baker, Campus Minister for the School of Medicine, extends a cordial invitation to members of the first year class to visit with him in his office as soon as they are settled in St. Louis. A regular program of spiritual exercises is conducted in the chapel of the School of Medicine.

ATTIRE

Dress comfortably, but very casual dress is discouraged. Student physicians are reminded of their obligation to conduct themselves in a manner befitting their dignity as members of the medical profession. Identification badges will be provided and must be worn while in the School of Medicine and university hospitals.

STUDENT HEALTH

Each entering medical student is required to undergo a complete physical examination that must be completed no sooner than 6 months prior to matriculation. A copy of the physician's report must be submitted on the form provided to: Director, Student Health and Counseling Center, Saint Louis University, 3520 Laclede, Marchetti Towers East, First Floor, St. Louis, Missouri 63103. An immunization record must be submitted with the physician's report of examination.

Upon registration at Saint Louis University School of Medicine, students will have the option of enrolling in a University Health Plan. A student's spouse and children may be covered by a family plan, but the difference in premium cost between the individual fee and the family coverage must be paid by the student. Detailed information will be available upon registration. If you would like to receive the information before Orientation, please call 314-977-5666.

In case of illness students are advised to seek professional care as needed. Psychiatric care is available immediately should this be necessary. If an illness interferes with academic responsibilities, please report this problem to the Office of Student Affairs.

COUNSELING

Members of the Office of Student Affairs are available and willing to counsel all students concerning an academic or personal problem. Difficulties of this nature are best handled when they first arise. Students should not procrastinate when confronted by a difficulty that could interfere with studies. Seek help with problems.

MISCELLANEOUS

Medical students are encouraged to participate in the wide range of cultural and social activities of the University at large. Recreation facilities, including the University Recreation Center and Busch Memorial Student Center on the north end of the University Campus are at your disposal.

Welcome, and congratulations!

Sincerely yours,

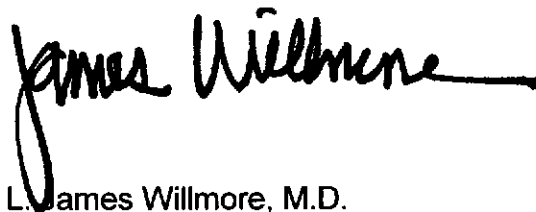
A handwritten signature in black ink that reads "James Willmore". The signature is written in a cursive style with a long horizontal line extending to the right.

L. James Willmore, M.D.
Associate Dean

**Saint Louis University
Student Immunization Record**

Please Print

_____	_____
Student Name	Banner ID Number
_____	_____
Permanent Address	Date of Birth
_____	_____
City, State, Zip	Sex
_____	_____
Phone	Intended Major, in known

Instructions:

1. Please read the University's Immunization Policy summarized on the last page of this document.
2. Complete all forms as directed. Please note that the Immunization History and Status Summary should be completed by the health care provider, and signed by a physician.
3. All students except those at the Madrid Campus should return forms to :
Director, Student Health and Counseling Center, Saint Louis University, 3518
Laclede, Marchetti Towers East, First Floor, St. Louis, MO 63103

Madrid students are to send forms to Foreign Student Advisor, Saint Louis
University, DuBourg Hall, Room 248, 221 North Grand, St. Louis, MO 63103

4. Completed forms must be returned by:

August 1 for Fall Semester
December 1 for Spring Semester
May 1 for Summer Semester

Authorization for Release of Immunization Data*

I authorize Saint Louis University to release this immunization record to public health authorities for compliance audits and/or in the event of a health or safety emergency, and to health care providers and institutions to which I may be assigned during my educational experience if I choose a health professions major.

Student Signature _____ Date _____

*Please note that this authorization is for the immunization record only.

PHYSICAL EXAMINATION

Student Name _____

M

F

Height _____

Weight _____

Blood Pressure _____ / _____

Pulse _____

Date _____

Vision R / L /

Corrected R / L /

NORMAL

1. General	
Musculature	
Nutrition	
Skin	
2. Head	
Eye	
Ear	
Nose	
Teeth	
Tongue	
Tonsils	
Pharynx	
3. Neck	
Nodes	
Thyroid	
4. Chest	
Lungs	
Heart	
5. Abdomen	
Organs	
Masses	
Hernia	
Extremities	
Reflexes	
Rectal	
Genitalia	

Recommendations of examining physician for follow up management examination or care:

URINE Sp. gr. _____ Alb. _____ Glucose _____ Micro _____

Physician Name _____

Address: _____

Physician Signature _____ M.D. Date: _____

Immunization History

Student Name _____

Banner ID Number _____

TO BE COMPLETED BY A HEALTH CARE PROVIDER:

<u>Vaccine or Test</u>	<u>Vaccine Type</u>	<u>Date(s)</u>	<u>Doctor or Clinic</u>
Polio (PPV or eIPV)	_____	Primary Series _____	_____

Diphtheria, Pertusis	_____	Booster _____	
		Primary Series _____	_____
Tetanus (DPT, DT or Td)	_____	_____	_____
		Booster(s) _____	
Combination MMR	_____	1 st Dose _____	_____
		2 nd Dose _____	_____
Measles	_____	1 st Dose _____	_____
		2 nd Dose _____	_____
Mumps	_____	_____	_____
Rubella	_____	_____	_____
Meningitis	_____	Waiver _____	_____
Other Vaccines	_____	_____	_____
Tuberculin Test	_____	_____	_____
Result	_____		

N.B.: Positive skin test requires a separate physician statement documenting absence of active/infectious tuberculosis.

7. Have you ever had a head injury, concussion, broken bones or other serious injury?
Yes No
If yes, indicate what injury and when.

8. Have you ever had an operation? Yes No
If yes, indicate for what and when.

9. Please indicate if you have a history of any of the following:

<input type="checkbox"/> Heart Murmur	<input type="checkbox"/> Fainting Spells
<input type="checkbox"/> Irregular Heart Beat	<input type="checkbox"/> Sleep Disorder
<input type="checkbox"/> High Blood Pressure	<input type="checkbox"/> Menstrual Disorder
<input type="checkbox"/> Rheumatic Fever	<input type="checkbox"/> Seizure Disorder
<input type="checkbox"/> Bleeding Disorder	<input type="checkbox"/> Psychiatric Disorder
<input type="checkbox"/> Diabetes	<input type="checkbox"/> Alcohol Abuse
<input type="checkbox"/> Hypoglycemia	<input type="checkbox"/> Substance Abuse

10. Do you have any dietary restrictions for medical reasons? Yes No
If yes, please specify.

11. Do you have any physical limitations? Yes No
If yes, please specify.

Immunization Status Summary

Student Name _____

Banner ID Number _____

TO BE COMPLETED BY HEALTH CARE PROVIDER

Please respond to the following, which summarize the immunization requirements for Saint Louis University:

1. The student has completed a primary series of diphtheria and tetanus immunization. Yes No
2. The student has had a tetanus booster within the past ten years. Yes No
3. The student has received at least one dose of Rubella and Mumps vaccines Yes No

If No, is there documentation of physician diagnosed illness (mumps _____), or laboratory evidence of immunity (rubella _____, mumps _____)?
Please attach documentation/evidence.

4. The student has received two doses of measles vaccine (alone or in combination) on or after first birthday. Yes No

If No, is there documentation of physician diagnosed illness _____ or Laboratory evidence of immunity _____?
Please attach documentation/evidence.

5. The student has had a negative tuberculin test within the past 12 months. Yes No

Physician Name _____

Address _____

Physician Signature _____

Date _____

Exemptions

1. Students claiming exemption from immunizations because of medical contraindications must submit a written statement signed and dated by a physician.
2. Students claiming exemption from immunizations because of religious beliefs must submit a written statement, signed and dated by the student (or parent/guardian if the student is a minor) describing his/her objection to immunization based upon bona fide religious beliefs or practice.

Saint Louis University Student Immunization Requirements

Diphtheria and Tetanus

Documentation of primary series of diphtheria and tetanus toxoid, and a booster within the past ten years.

Measles

Documentation of two doses of live measles (or MMR combined) vaccine separated by at least one month on or after the first birthday, or, documentation of physician-diagnosed disease or laboratory evidence of immunity. Because routine childhood immunization schedules for two doses of Measles vaccine have only recently been implemented most students now entering the University will need the second dose for live measles vaccine. Individuals who received killed measles vaccine, combination of killed and live measles vaccine, or measles vaccine of an unknown type in the period 1963-1978 are considered unvaccinated, and should receive two doses of live vaccine at least one month apart.

Mumps

Documentation of one dose of live mumps (or MMR combined) vaccine on or after the first birthday, or, documentation of physician-diagnosed mumps or laboratory evidence of immunity. Person who received killed mumps vaccine which was available between 1950-1978 might benefit from revaccination.

Rubella

Documentation of one dose of rubella (or MMR combined) vaccine on or after the first birthday, or, documentation of laboratory evidence of immunity.

Tuberculin Test

Documentation of size of tuberculin skin test within the past 12 months. Positive skin tests require a separate physician statement documenting absence of active/infectious tuberculosis.

Polio

Polio vaccine is not routinely given to adults, and therefore, students are not required to receive a booster or a primary series if they were not previously immunized. Students should, however, document their childhood polio vaccine immunization. In the unlikely event of epidemic disease, special requirements may be instituted.

Hepatitis

Immunization against Hepatitis B is strongly recommended for all students and is required for health professions students prior to their clinical assignments.

Applicability, Documentation and Enforcement

1. This policy applies to all domestic and international students entering the University for the first time, unless medical or religious exemptions pertain. Students in the School of Professional Studies must only comply with the requirement related to tuberculin testing.
2. Submissions of this record, by the date specified, is mandatory. Failure to comply will result in registration being cancelled and/or restricted.
3. The University also reserves the right to deny access to campus facilities, including residence halls, if documentation of compliance has not been provided. Further, in accordance with public health recommendations, non-immune students may be excluded from the university campus in the event of a measles, rubella, mumps or diphtheria outbreak or other public health recommendation.

IMPORTANT Orientation Week Information from the Office of Student Affairs

On behalf of the Orientation Committee, I would like to congratulate you on your acceptance to Saint Louis University School of Medicine. We have planned a week full of activities to help you feel more comfortable in your new environment. This week will give you the opportunity to get to know your classmates, meet some members of the faculty, explore parts of St. Louis, and have fun in the process. **PLEASE, PLEASE Fill Out the Online Survey for Social Events, which will be up on the Medical School website shortly (medschool.slu.edu).** You can follow the links to a draft of the **2011 Orientation Schedule and an Invitation to the White Coat Ceremony.** Housing information is also available on our website.

Sunday, July 31 is the White Coat Ceremony, sponsored by the School of Medicine and the Medical Alumni Association. Entering students will be given their first white coats, the symbol of the medical profession. The ceremony is meant to foster professionalism and humanism in medicine. Parents, spouses, and family are invited to attend the ceremony at 1:30 pm on August 1 at St. Francis Xavier College Church (North Campus Map 1; #51) and a reception for everyone follows. **Entering students need to get to the Church by 12 Noon to be fitted for their white coat.** So, if you live near St. Louis, or if your parents and friends are accompanying you here that week, **PLEASE, PLEASE** invite them for this very special occasion. An **Invitation for Family and Friends** with directions and maps is included in this packet. **Physician family members are welcome to participate in the "hooding" portion of the ceremony.** University Maps can also be found on our website at www.slu.edu/campusmap. This is one very special occasion; the beginning of your career in the medical profession. Bring cameras!

Convocation begins on **Monday, August 1 at 8:30 am** in our new Student Education Union (#23 on the Medical Center map). Please park in the Hickory East Garage, 1214 S. Theresa Avenue (Garage #13). For this day, the appropriate attire is "nice casual"; wear comfortable shoes, as the activities of the day require a lot of walking. You will be registered, have official pictures taken for your medical school I.D. card, be given an introduction to the School, receive health insurance and housing information, and you will be assigned a locker. Please bring a combination lock or padlock for your locker that day. The rest of the week will be casual (shorts, T-shirts, etc.) and will provide a variety of other information about medical school life and the curriculum, financial aid, and extracurricular student organizations. It will offer some great social events and activities, all to acquaint you with your new environment and your fellow colleagues. New this year is a Community Service Day on Friday, August 5. Groups of students will participate in a variety of community service activities and finish the day at our Official Welcome Picnic and Softball Tournament. Please check the "Preliminary" Welcome Week schedule. Some social events are free and others have nominal costs for tickets and/or transportation. Please complete the online survey when it is available to help us plan for these events.

We encourage you to arrive in St. Louis early enough to find housing so that you will be able to participate in and enjoy Orientation. **PLEASE NOTE...** Housing information is available on the School of Medicine website. You may also call Mrs. Susan Aslin, Administrative Assistant, Office of Student Affairs for housing updates and lists of students seeking roommates at 314-977-9827. We look forward to welcoming you to St. Louis and hope that we can make your transition to your first year of medical school as smooth as possible. If you have any questions, please do not hesitate to contact us. We look forward to meeting you.

Dr. James Swierkosz, Assistant Dean of Students

**(Preliminary) SCHEDULE FOR MEDICAL STUDENT WELCOME WEEK
AUGUST 2011**

Student Affairs Sponsors: Dr. James Swierkosz, Dr. L. James Willmore, and Mrs. Susan Aslin
Welcome Week Student Event Coordinators: Elyse Shaw and Chad Mahan
Orientation Support Group Student Coordinators: Jennifer Ray, Elyse Brinkmann, Dwayne Corcoran
Community Service Day Coordinator: Robert Hilton

Sunday, July 31 WHITE COAT CEREMONY

1:30 **WHITE COAT CEREMONY – St. Francis Xavier College Church**

3:30 **RECEPTION – Students, Parents and Guests – Class of 2015**
Simon Recreation Center – Sponsored by the Medical Alumni Association
Presentation by the student coordinators of the Health Resource Center Free Clinic

Monday, August 1 INTRODUCTION TO THE SCHOOL

8:30 **Orientation Information Packets – Student Education Union (Bldg 23 – Medical Center Map)**
Continental Breakfast - Compliments of the U.S. Air Force Medical Program

9:00 **WELCOME and INTRODUCTION to the School of Medicine:**
Philip O. Alderson, M.D., Dean, School of Medicine
L. James Willmore, M.D., Associate Dean, Admissions & Student Affairs
James E. Swierkosz, Ph.D., Assistant Dean, Student Affairs
Stuart Slavin, M.D., MEd., Associate Dean, Curricular Affairs
Michael Railey, M.D., Associate Dean, Multicultural Affairs
James Baker, S.J., Director, Campus Ministry
MS-2 Student Orientation Hosts

9:45 **Student Information Session – Health insurance; Email access, student records & courses**
Robert Heaney, M.D., Associate Dean, on Health Insurance Information
Patrick McCarthy, Director, Medical Center Library
Ted Stahl, ITS Technology Manager for the School of Medicine

10:15 **REGISTRATION & TOURS (Join your Orientation Groups – Group # on your folder)**
Class Photos
Tours of the Education Union, Medical School complex and Hospital
Health & Dental Insurance information
Banking information
Housing information
Armed Services Scholarship information
Orientation week “Events Sign-Up” Tables
Medical School, Library & Hospital - Tours & Information
I.D. Badges / Parking Permits – basement of Caroline Bldg.

12:30 **Welcome Luncheon with Orientation Support Groups**
Multipurpose Room, 3rd floor Doisy College of Health Sciences

2:00 **Student Financial Services Information Session – Education Union**
Sandy Pritt, Director, Student Financial Services
Information regarding scholarships, grants, loans and other financing programs

3:00 **HIPAA Training Session (REQUIRED in order to participate in clinical situations)**
Sally Frese, Office of Compliance

6:30 - 8 pm **Campus Ministry's "Welcome Pool Party and BBQ"**
Simon Recreation Center's Outdoor Pool & Palm Trees (flyer available at Orientation)
Sponsored by Fr. James Baker and Campus Ministry

Tuesday, August 2 STUDENT INFORMATION SESSIONS

8:30 **Continental Breakfast** – Student Education Union
Compliments of the U.S. Army Medical Program

9:00 **The M.D. Program: Office of Curricular Affairs**
An Overview of the Curriculum, Electives, Academic Policies & the new Learning
Communities
Stuart Slavin, M.D., M.Ed., Associate Dean, Curricular Affairs
William Mootz, M.D., Assistant Dean, Curricular Affairs
Gregory Smith, Ph.D., Director, Phase 1 Curriculum, Assistant Dean, Educational Development

10:00 **Break**

10:15 **The Medical School Experience:** Medical School Perspectives from a Panel of SLU Students

11:30 **Campus Security Information for Students:** Office of Public Safety

12:00 **LUNCH – Out on the Town with Student Support Groups**
Join your Support Groups to explore some of St. Louis' dining and recreational treasures

5:00 - 7:00 **American Medical Women's Association (AMWA) Medical Student/Faculty Social**
(flyer available at Orientation)

8:00 pm **Bowling Night at Tropicana Lanes** (fun night for bowlers and non-bowlers alike)

Wednesday, August 3 RESOURCES for MEDICAL STUDENTS

8:30 **Continental Breakfast** – Student Education Union
Compliments of the U.S. Navy Medical Program

9:00 **Academic & Personal Resources for Success in Medical School:**
Professionalism in Medicine, Personal, Academic, and Career Counseling
L. James Willmore, M.D. - Associate Dean, Admissions & Student Affairs
James E. Swierkosz, Ph.D. - Assistant Dean, Student Affairs
Michael Railey, M.D. – Associate Dean, Multicultural Affairs

Paths to Thriving in Medical School
Stuart Slavin, MD, Associate Dean, ACS1 course director
Ginny Fendell, MSW

Office of Campus Ministry – Resources for Students
James Baker, S.J. - Director, Campus Ministry

- 11:30 **An Introduction to Student Organizations:**
 Health Resource Center (A Student-Operated Open-Door Clinic)
 Casa de Salud (Community Hispanic clinic)
- 12:00-2:00 **The BOOK FAIR – Room M300 (med school)** (Great prices on USED books; time is by lottery)
- 12:00 **A Survey of Organizations for Students: Education Union Café and Lounge areas**
 Wellness Interest Group & Learning Community Child Abuse Prevention Task Force
 AMA Interfaith Student Interest Group
 AMSA Student Follies Organization
 Student National Medical Association (SNMA) SPOTS
 AMWA and the Women’s Liaison Group Tar Wars
 APAMSA (and others)
 AIDS Education Task Force
 Student Class officers
 Health Resource Center – The Student-run Open Door Clinic
- Career Specialty Groups:**
 Family Practice Interest Group Surgery Interest Group
 Geriatrics Interest Group Internal Medicine Interest Group
 Pediatrics Interest Group Sports Medicine Interest Group
 Emergency Medicine Interest Group OB/Gyn & Women’s Health Group
 (and others)
- 12:15 **Military Health Professions Scholarship Session**
 (for those students interested in Military Scholarships)
- 1:00-3:00 **HRC Clinical Training Session**
- 1:30 pm **The Orientation “Solar Open”**
 Golfers and Hackers of all skills can get together for 9 holes of fun on the links at the Highlands Golf Course in Forest Park. (clubs can be shared if you don’t have any)
- 7:30 pm **A Night at the Museum – St. Louis’ Hallmark City Museum**
 A night of fun and history

Thursday, August 4 CPR Training Day (if already CPR certified, bring your certification card)

- 7:30 am - **Meet in LRC lobby for group CPR assignments.** Refreshments courtesy of AMSA
 5:00 pm
 Noon – 1pm **AMA-Sponsored Lunch (LRC-A) –** Come and learn more about the student AMA organization.

Friday, August 5 COMMUNITY SERVICE DAY

- 8:15 am **Continental Breakfast –** Student Education Union
 Compliments of the Office of Student Affairs and the Office of Multicultural Affairs
- Strategy Session for Service Projects -** then divide into Service Work Groups
- 9am – 1:00pm **Individual Service Projects –** at Multiple Locations
- 2:00 pm - **WELCOME WEEK CLASS PICNIC – in Tower Grove Park (Turkish Shelter)**
 Sponsored by the Offices of Student and Multicultural Affairs – A Not-To-Be-Missed Event
 (check flyer for map, details, and activities)
 (including the infamous “First Year vs Second Year Softball Tournament”)

Saturday, August 6

8:00am- **Float Trip** (on the Meramec River) - (see flyer for details)
6:00pm

Sunday, August 7

Eucharist - St. Francis Xavier College Church: Masses at 8:30, 10:30, 4:30pm

3:00 pm **Family Picnic** – Location to be determined
(students with spouses, children, significant others) – flyer available at Orientation

Monday, August 8 "CLASSES BEGIN"

Student Affairs Sponsors: Dr. James Swierkosz, Dr. L. James Willmore, and Mrs. Susan Aslin

**Any Questions contact us at Office of Student Affairs, Rm. Caroline 100
(314)-977-9827
Email: aslin@slu.edu or swierkoszje@slu.edu**

To Parents and Family of the Class of 2015

The Dean, Faculty and Students
Of the
Saint Louis University School of Medicine
Invite you to attend

**The White Coat Ceremony
For the Class of 2015**

Sunday, July 31, 2011
1:30 P.M.

St. Francis Xavier College Church
3628 Lindell Blvd. (corner of Grand Blvd.)
St. Louis, Missouri

Reception immediately following

The White Coat Ceremony creates a psychological contract for professionalism and empathy in the practice of medicine from the very start of medical training. This is symbolized by investing each student with a clinical White Coat, the mantle of the profession. Please join us as a special guest for this very important ceremony.

For your convenience, the University North Campus map is included in this packet. The ceremony will be held at St. Francis Xavier College Church (University North Campus Map, Building #51) and parking is available at the Laclede St. Garage (Garage #25 just down the street at the corner of Grand and Laclede). Drop-off for handicapped individuals is possible at the front of the Church on the corner of Grand Blvd. and Lindell. Parking is free for those attending the ceremony.

A reception sponsored by the Alumni Association of the School of Medicine will follow in the Simon Recreation Center (Building #50 on the North Campus Map). University Campus Maps can also be found on the University website at www.slu.edu/campusmap. We hope to see you all there.

For further information, please call the Office of Student Affairs at 314.977-9827.

SAINT LOUIS UNIVERSITY NORTH CAMPUS

Premium, preferred and general parking lots are available to all permit holders

Monday-Friday 5:30 p.m. - 2 a.m.
Saturday-Sunday 6 a.m. - 2 a.m.

In the preferred garage locations, parking is available beginning at 4:00 p.m.

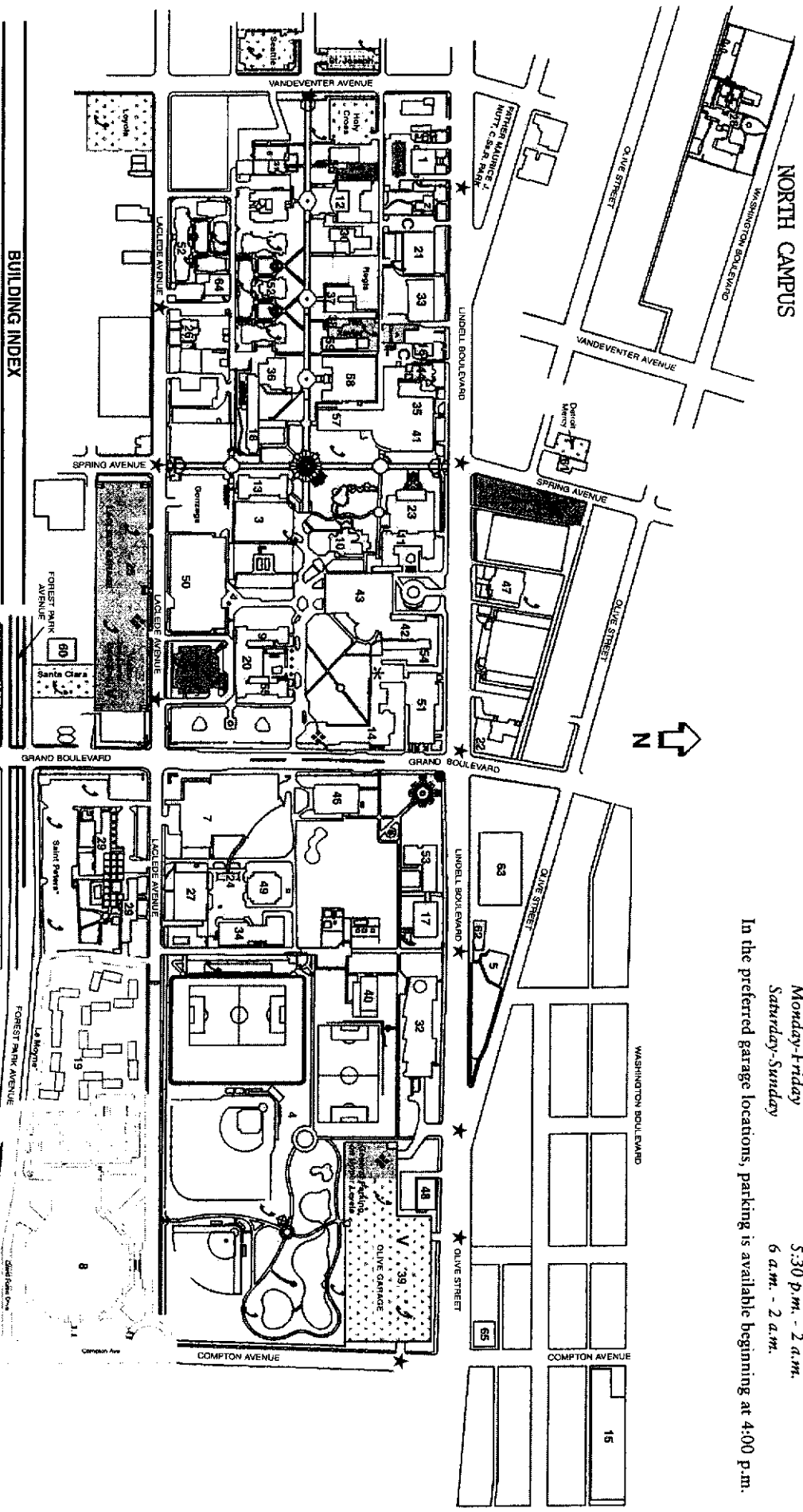

BUILDING INDEX

- 1 Academic Resources Center
- 2 Barnier House
- 3 Baumier-Eberhardt Athletic Center
- 4 Billiken Sports Complex
- 5 Biomedical Engineering Building
- 6 Bolebu Hall
- 7 Busch Student Center
- 8 Chalatz Arena
- 9 Clemens Hall
- 10 Couples House and McKamee Gallery
- 11 Davis-Straughness Hall
- 12 DeKalbes Hall
- 13 Des Peres Hall
- 14 DUBourg Hall
- 15 EARTH Hall
- 16 Family Development Center
- 17 Fitzgerald Hall
- 18 Fuzt Hall
- 19 Grand Forest Apartments
- 20 Greenedock Hall
- 21 Humanities Building
- 22 Jesuit Hall
- 23 John & Lucy Cook Hall
- 24 Kelley Auditorium/Lecture Halls
- 25 Laclede Parking Garage
- 26 Language Houses
- 27 Marchessault Hall
- 28 Marneva Center
- 29 Marchell Towers
- 30 Marguerite Hall
- 31 Maxton Runsey-Carter Hall
- 32 McDonnell Douglas Hall
- 33 McCannan Hall
- 34 Monsanto Hall
- 35 Museum of Contemporary Religious Arts
- 36 Museum of Contemporary Religious Arts
- 37 Notre Dame Hall
- 38 O'Brien Hall
- 39 Olive Parking Garage
- 40 Oliver Hall
- 41 Omer Pees Law Library
- 42 O'Neill Hall
- 43 Pius XII Memorial Library
- 44 Queen's Daughters Hall
- 45 Reiter Hall
- 46 Ritter Hall
- 47 Saint Louis University Museum of Art
- 48 School for Professional Studies
- 49 Shannon Hall
- 50 Simon Recreation Center
- 51 St. Francis Xavier Church
- 52 Student Village Apartments
- 53 Tepper Hall
- 54 Verhaegen Hall
- 55 Walsh Hall
- 56 Wolf Building
- 57 Wolter Hall
- 58 Xavier Hall
- 59 Xavier Hall Annex
- 60 3631 Forest Park Ave
- 61 321 N. Spring
- 62 3515 Lindell
- 63 3545 Lindell
- 64 3761 Laclede Ave
- 65 3205 Olive St

LEGEND

- 24-hour Reserved Parking
- Premium Parking
- Preferred Parking
- Commuter/Faculty/Staff General Parking
- Resident Parking
- Evening (5:30 p.m.-2 a.m.) & Weekends (6 a.m.-2 a.m.) Parking
- Visitor Parking
- Client Parking/24-hour Reserved Parking
- Emergency Telephones
- Department of Public Safety
- Parking and Card Services-DB33
- Billiken Loop Shuttle

SAINT LOUIS UNIVERSITY Medical Center

Premium, preferred and general parking lots are available to all permit holders

Monday-Friday 5:30 p.m. - 2 a.m.
Saturday-Sunday 6 a.m. - 2 a.m.
 In the preferred garage locations, parking is available beginning at 4:00 p.m.

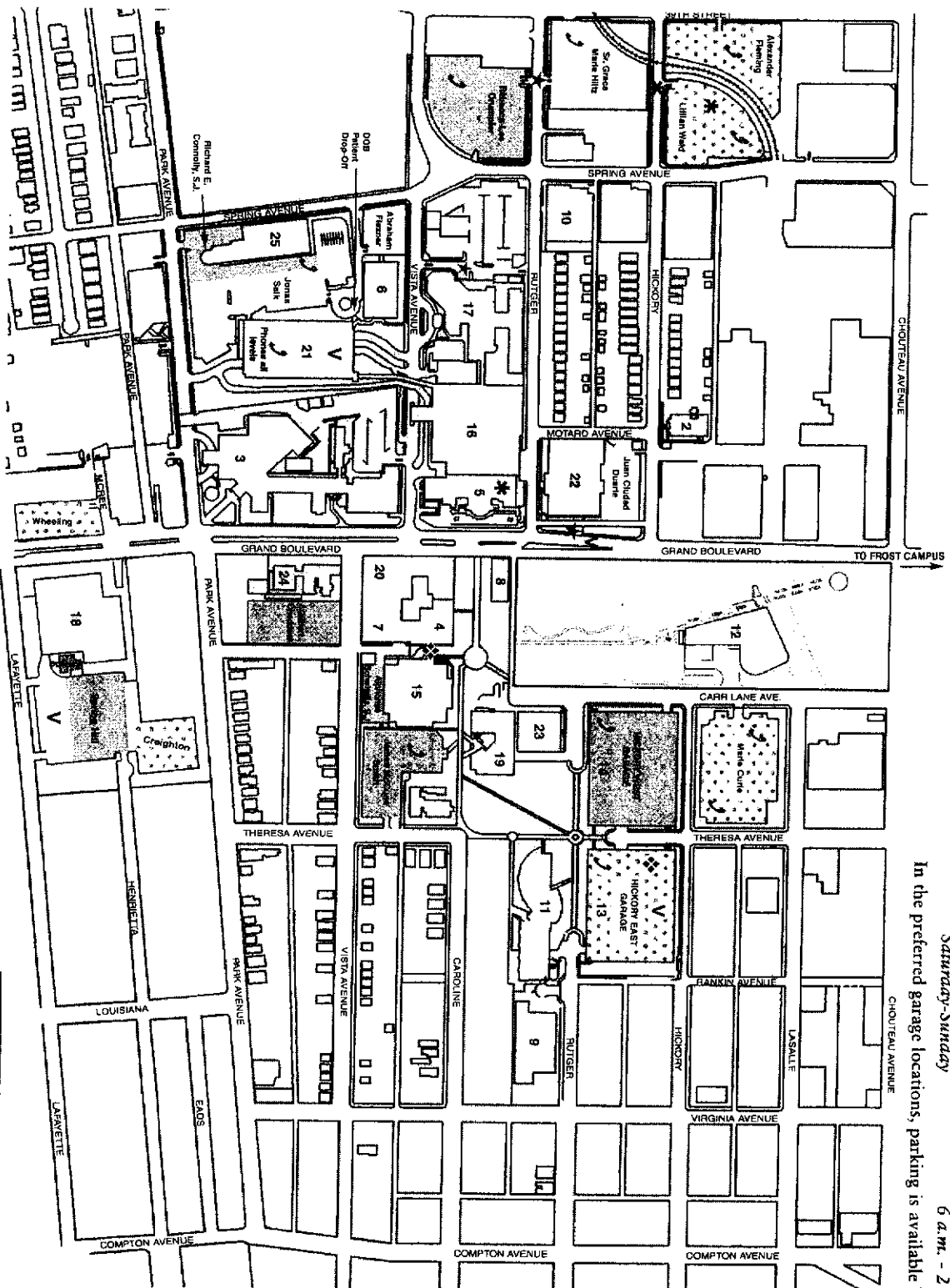

LEGEND

- Reserved Parking
- Premium Parking
- Preferred Parking
- General Parking
- Evening (5:30 p.m.-2 a.m.) & Weekends (6 a.m.-2 a.m.)

V Visitor Parking
C Client Parking/24-hour Reserved Parking
 Emergency Telephones
 Department of Public Safety
 Hospital Protective Services
 Tenet HSC Shuttle

BUILDING INDEX

- | | | |
|--|-------------------------------------|---|
| 1 Anheuser-Busch Institute* | 10 Durremond Hall | 18 Salus Center/Water Tower Inn |
| 2 Auxiliary House* | 11 Edward and Margaret Dossy | 19 School of Nursing |
| 3 Cardinal Glennon Children's Hospital* | 12 College of Health Professions | 20 Schwilke Hall |
| 4 Caroline Building | 13 Edward A. Dossy Research Center | 21 Vista Parking Garage* |
| 5 Desloge Towers* | 14 Hickory East Parking Garage | 22 Wash Institute* |
| 6 Doctors Office Building | 15 Hickory West Parking Garage | 23 Learning Resource Center |
| 7 Daisy Hall | 16 Learning Resource Center | 24 Saint Louis University Hospital* |
| 8 Danco Building | 17 Saint Louis University Hospital* | 25 Saint Louis University Cancer Center/ Saint Louis University Hospital West Pavilion* |
| 9 Drexel/Marshall Center for Advanced Dental Education | | |

* Other Affiliated Institutions

23 Education Union

The Saint Louis University Chapter of the American Medical Student Association

Dear First-Year Medical Student:

CONGRATULATIONS on your admission to Saint Louis University School of Medicine! While medical school involves many hours in the classroom and studying, at SLU there are plenty of opportunities to get involved in politics, advocacy, community service and leadership. AMSA is one of many student organizations through which you can take advantage of these opportunities.

AMSA is the nation's oldest and largest independent student association. Nationally, AMSA advocates for the interest and well-being of patients, medical students and residents. AMSA's current strategic priorities are: Diversity in Medicine, Transforming the Culture of Medical Education, Fighting for Universal Health Care and Eliminating Health Disparities. As a member, you can get involved in many ways, both locally and nationally.

On the national level, there are numerous leadership training institutes happening all year long. You can also get involved through summer fellowships and internships.

Locally we have many events, including community service opportunities, social events, guest speakers and networking events, World AIDS Awareness events, book drives, and fundraising for student scholarships to travel and serve abroad. These are just a few of the many ways that you can get involved.

Remember to join AMSA during Orientation Week (5 years of Membership for only \$75)

When you join AMSA and sign up for the AMSA credit card, you can receive a **FREE NETTER** *Human Anatomy Atlas* worth \$75.95 and a **MUST HAVE** for gross anatomy. Please see your AMSA representatives at the booth during Orientation for details on this gift option and others. Also, when you join AMSA, you will receive a free subscription to *The New Physician* magazine for the life of your student membership and other membership benefits, including discounts on hotel, car rental, books, PDAs, and insurance for health, life, auto and homeowners. Go to www.amsa.org/member/benefits.cfm to view all of the benefits available.

Again, WELCOME TO SLU. For more information, feel free to contact us or visit AMSA's Web site at www.amsa.org. Enjoy the rest of your summer; we look forward to seeing you in August.

Sincerely,

Sarah Kuehnle and Myles Dickason
President
sarah.kuehnle@gmail.com
mylesdickason@gmail.com

Jon Yoon
Treasurer
yoonyk@slu.edu

Reena Varade
Recruitment Chair
varaders@gmail.com



Medical Student AMSA Membership Application

American Medical Student Association, 1902 Association Dr., Reston, VA 20191 Phone: (800) 767-2266 Fax: (703) 620-5873
Web: www.amsa.org Email: members@amsa.org

Medical students enrolled in or on leave of absence from any LCME or AOA accredited or provisionally accredited North American allopathic or osteopathic training program are eligible for membership. Please see below for membership dues

PLEASE TYPE OR PRINT CLEARLY

First Name Middle Name Last Name

Permanent Address: Street Apt/Room

City State Zip Country

Mailing Address at School (if applicable): Street Apt/Room

City State Zip Country

Please indicate preferred mailing address: Permanent/School (Please Note: If an international mailing address is indicated as preferred a one-time charge of \$50 will be added to the membership dues.)

Home Phone Number Cell Phone Number

Preferred E-mail Address Alternate E-mail Address:

Medical School Attending

Medical School Location Graduation Date (mm/yyyy)

Intended Medical Specialty

Gender Birth Year (yyyy) Nationality

Members are entitled to receive, at no additional charge AMSA's award winning magazine, The New Physician. Please check one of the following:

- () Yes, please send me The New Physician magazine as part of my membership
() No thank you I do not want to receive The New Physician magazine

DUES AND FEES—Dues are in U.S. Currency.
Medical Member Dues: \$75 for duration of medical school training or a combined medical school program. If an international address is indicated as the preferred address please add a one-time fee of \$50 to your membership dues.

Dues: \$

International Address Fee \$

TOTAL ENCLOSED: \$

- () Payment enclosed (make checks payable to AMSA)
() Please charge my: VISA MasterCard American Express

Account Number Exp. Date CCV:

Signature Today's Date

MEMBERSHIP DUES ARE NOT REFUNDABLE. Dues/contributions/gifts to AMSA aren't deductible as charitable contributions for federal tax purposes. However, dues may be deductible by members as an ordinary and necessary business expense. Consult your tax adviser. AMSA is committed to keeping members informed of important changes in medical education and health care delivery, especially where new and innovative opportunities are available. We aim to keep announcements informative and infrequent. AMSA has a strict review process for any information disseminated from external sources. AMSA will inform its members of beneficial services available from these other entities, subject to approval by the AMSA Board of Trustees. If you do not wish to receive information from these AMSA-approved outside organizations, please indicate:

- () Do not release my address. () Do not release my e-mail address. () Do not release my phone number.

Please mail this application with your payment to: AMSA Membership Services, 1902 Association Dr, Reston, VA 20191
Questions? Call: 1 (800) 767-2266, E-mail: members@amsa.org or Visit: www.amsa.org



SAINT LOUIS UNIVERSITY

SCHOOL OF MEDICINE 2011-2012 Schedule of Rates

Tuition	\$46,510
Health Insurance*	\$2,280
Medical Student Service Fee for 1st and 2nd year students	\$140
Medical Student Service Fee for 3rd and 4th year students	\$40
Student Government Association (SGA) – Student Activity Fee	\$60
Clinical Education Compliance Fee **	\$105
Student Union Fee	\$100
Technology Fee	\$100
Wellness Fee	\$180
Readership Fee	\$5
Graduation Fee – one-time fee for 4th year students	\$100
General Parking Fee***	\$400

Note: All of the above rates are yearly rates and are subject to change. Please refer to the Student Financial Services School of Medicine's website at <http://medschool.slu.edu/sfs> for updates.

* Health insurance can be waived when the student provides a completed waiver form and proof of insurance. The listed insurance amount is for student only coverage. Additional insurance options are available. Visit the University Health Plan web site at <http://medschool.slu.edu/uhp/> or contact the office at 314-977-5666 for additional information.

** Onetime fee that is charged when students complete their background check.

***For additional parking options, please contact Parking and Card Services at (314) 977-8656.



SAINT LOUIS UNIVERSITY

SCHOOL OF MEDICINE 2011-2012 Simple Budget Sheet

Estimating your total financial needs at the beginning of each academic year can assist you in prudent borrowing and save you thousands of dollars in interest accrual. Use this simple worksheet to estimate your budget and help limit your level of student loan indebtedness.

Section One: Detailed below are the total estimated fixed costs for the academic year.

Tuition		\$ 46,510
Fees		
M1 Fees \$690, M2 Fees \$585, M3 Fees \$485, M4 Fees \$585	+	
Books and Supplies		
This is an estimate of the average books and supplies; your actual expense may vary.		
M1 Books and Supplies \$980, M2 Books and Supplies \$631, M3 Books and Supplies \$851, M4 Books and Supplies \$201.	+	
USMLE Exam Fees		
M3 students only please visit www.nbme.org/students/examfees.html to review the current exam fees	+	
Health Insurance		
Can be waived for the academic year with a completed waiver form and proof of health insurance.	+	2,280
General Parking		
This is an estimate of the average parking expense for first year students; your actual expense may vary.	+	400
Total estimated fixed expenses:		=

Section Two: Use the spaces below to estimate your living expenses for the 2011-2012 academic year.

Yearly Rent Expense:

If you have roommates, use only your portion of the monthly rent expense.
Estimate your monthly expense then multiply by 12

Monthly: \$ _____ x 12 = + \$ _____

Yearly Utilities Expense:

Such as: water, electricity and phone
Estimate your monthly expense then multiply by 12

Monthly: \$ _____ x 12 = + \$ _____

Yearly Food Expense:

Such as: groceries and eating out
Estimate your monthly expense then multiply by 12

Monthly: \$ _____ x 12 = + \$ _____

Yearly Transportation Expense:

Such as: gas, basic vehicle maintenance, or public transportation
Estimate your monthly expense then multiply by 12

Monthly: \$ _____ x 12 = + \$ _____

Yearly Miscellaneous Expenses:

Such as: personal care products and entertainment
Estimate your monthly expense then multiply by 12

Monthly: \$ _____ x 12 = + \$ _____

Total living expenses: = \$ _____

Total budget amount: = \$ _____

Add the total fixed and living expense amounts together

Use your total budget amount to assist you in determining the amount you should accept from the financial aid offered on your award letter. You will have the opportunity to borrow additional funds up to the cost of attendance throughout the year.

PLEASE INDICATE YOUR WHITE COAT SIZE:

The sizes available are 32, 34, 36, 38, 40, 42, 44, 46, 48, 50, 52, and 54.

Men: Your sport coat/suit coat size

Women: Your sweater size

**Please e-mail this information to Susan Aslin
(aslin@slu.edu) in the Office of Students Affairs.**

**School of Medicine
2011 - 2012 Academic Calendar**

2011

June 1	Wednesday	Year 4 – Convocation – 3:00 p.m., MS Lecture Hall 4
June 20	Monday	Year 4 – Academic year begins
July 4	Monday	Year 3 – July 4 th Holiday
July 5	Tuesday	Year 3 – Orientation/Academic year begins – 9:00 a.m., LRC Pitlyk Auditorium A
July 31	Sunday	Year 1 – White Coat Ceremony – College Church
August 1-5	Mon-Fri	Year 1 – Orientation (Begins at 8:00 a.m. in LRC Pitlyk Auditorium)
August 8	Monday	Year 1 & 2 – Academic year begins
August 8	Monday	Year 2 – Convocation – 2:30 p.m., MS Lecture Hall 3
September 1	Thursday	Mass of the Holy Spirit
September 1	Thursday	DEADLINE FOR TUITION PAYMENT – 5:00 p.m.
September 5	Monday	Year 1, 2, & 3 – Labor Day Holiday
November 21-25	Mon-Fri	Year 1 & 2 – Thanksgiving Holiday Year 3 – (Begins at 6:00 p.m. on Wednesday)
December 18 – Jan 2 nd	Sun-Mon	Years 1, 2, 3 & 4 – Christmas Holiday

2012

January 3	Tuesday	Year 1, 2, 3, & 4 – Academic year resumes
January 16	Monday	Year 1 & 2 – Martin Luther King Holiday Year 3 & 4 – (To be determined by department)
March 10-18	Sat-Sun	Year 1 & 2 – Spring Break
March 16	Friday	Year 4 - Match Day
April 6-8	Fri-Sun	Year 1 & 2 – Easter Holiday Year 3 & 4 – (To be determined by department)
May 4	Friday	Year 2 – Academic year ends
May 6	Sunday	Year 4 – Academic year ends
May 17	Thursday	Senior Class Day Ceremony (Tentative)
May 19	Saturday	University Commencement
May 18	Friday	Year 1 – Academic year ends
May 28	Monday	Memorial Day Holiday
June 15	Friday	Year 3 – Academic year ends



3556 Caroline Mall
Caroline Building, Room 207
St. Louis, MO 63104
Phone 314-977-8071
Fax 314-977-8670
www.slu.edu

SAINT LOUIS
UNIVERSITY

School of Medicine Campus Ministry

June 2011

Dear Member of the Class of 2015:

Campus Ministry welcomes you to the St. Louis University School of Medicine!! I am Fr. Jim Baker, S.J., campus minister for the School of Medicine. Please drop in at the Campus Ministry Office early during your first year so we can meet. Any second, third, or fourth year student will tell you that this office is the coolest place in the whole Med School.

Campus Ministry is here because St. Louis University wants to support you personally and professionally during your medical studies. We expect you to grow in many ways, including spiritually. Campus Ministry can be a resource to you in dealing with issues of faith, times of stress, times of personal or family crisis, etc. Our service is confidential, complimentary, and very easy to access. We serve students of all faiths in a way that is respectful of each one's religious tradition. Also, we can provide information about the nearest church, synagogue, or mosque.

We provide a range of services. For example, Catholic Mass is celebrated each weekday at noon in the Chapel of St. Raphael located near the mailboxes on the second floor of the medical school. The Sacrament of Reconciliation is available on request. Also, there is an Interfaith Student Group and a Pro-Life Group, each of which meets over lunch for presentations and discussions several times a year. We provide Catholic marriage preparation, too. And, we will have two retreats during your first year: one will be an overnight; the other will be a "busy people's" format. Our first retreat this year will be overnight of Friday October 7-8. Mark this date on your calendar early.

So, let's meet during orientation week. Plan to come to the pool party, sponsored by Campus Ministry, Monday evening, August 1. Plan on it. There will be fun and food but, more importantly, it will be a comfortable place to meet your new classmates. Spouses and children are welcome. See the pool party flier for specifics.

Sincerely,

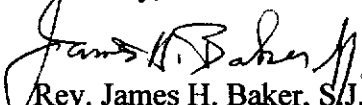
Rev. James H. Baker, S.J.
Director of Campus Ministry



Meet other members
of your class!!

POOL PARTY



Monday,
August 1,
Simon Rec Center
6:30 until 8:00

Spouses and your children welcome!
Finger food and beverages!
Sand volleyball!
Splash pools!

by Garpas Ministry

MARK YOUR CALENDAR
FOR THE EVENING OF
MONDAY, AUGUST 1,

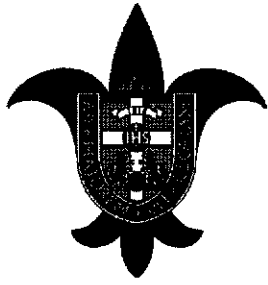

SAINT LOUIS UNIVERSITY

Class of 2015 T-Shirt

SILVER writing on NAVY shirt:

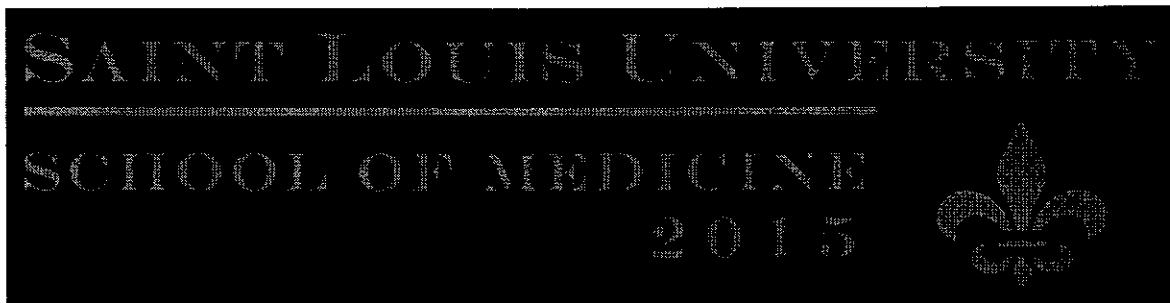

Make sure to place your order online at:
tinyurl.com/slu-2015

\$15 per shirt

Pick up at white coat ceremony reception

Please try to make your orders by **July 20**

Contact:

David Gill -- dgill6@slu.edu

Nick Wilson -- nwilso18@slu.edu